

the proposed development

The proposed site is in the Medworth ward of Fenland District Council. The facility fits into the industrial setting, on a site that is currently used as a waste transfer station. This industrial area in Wisbech offers opportunities to achieve high efficiencies with Combined Heat and Power (CHP).

what might it look like?

Since our non-statutory consultation last year, we have been working with architects to develop the external design of the main building.

We have listened to feedback and considered how the EfW CHP facility will fit into the existing landscape.

The EfW CHP Facility

A selection of shapes and designs have been considered for the main building:

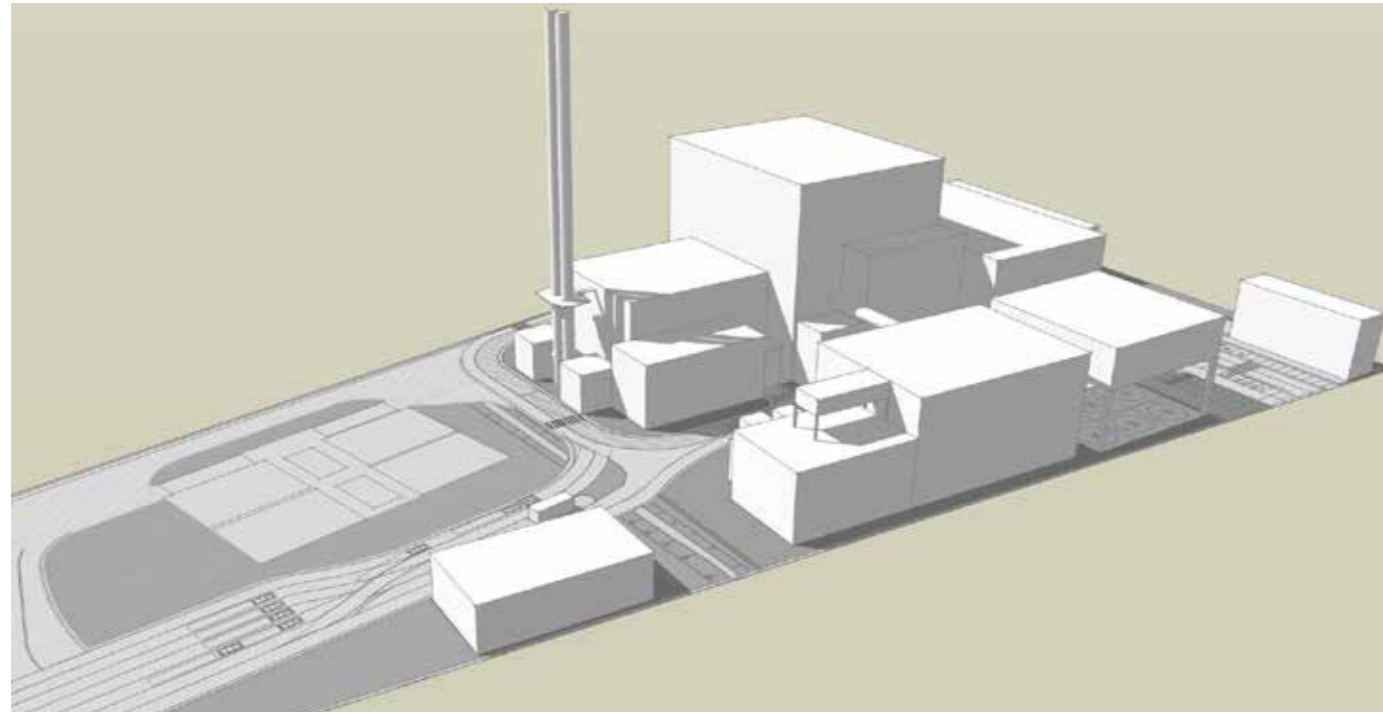

Massing model 2

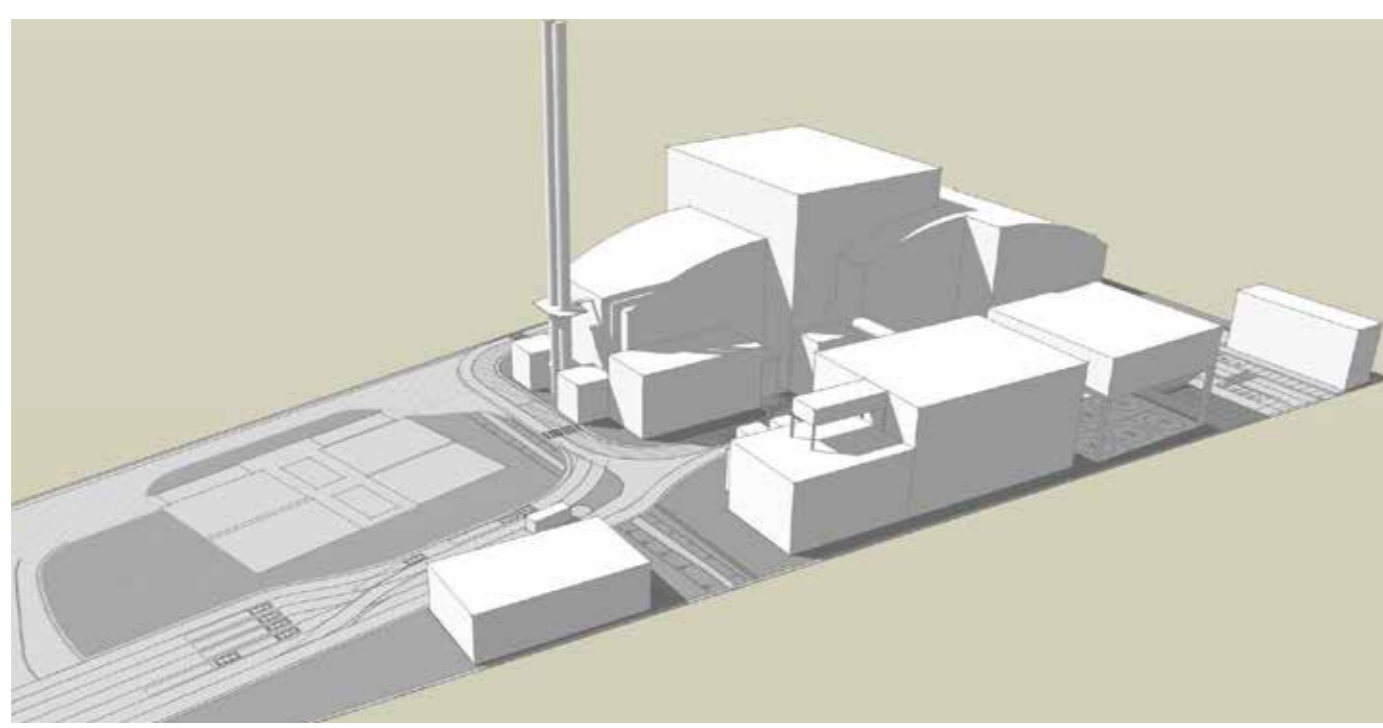

Massing model 3

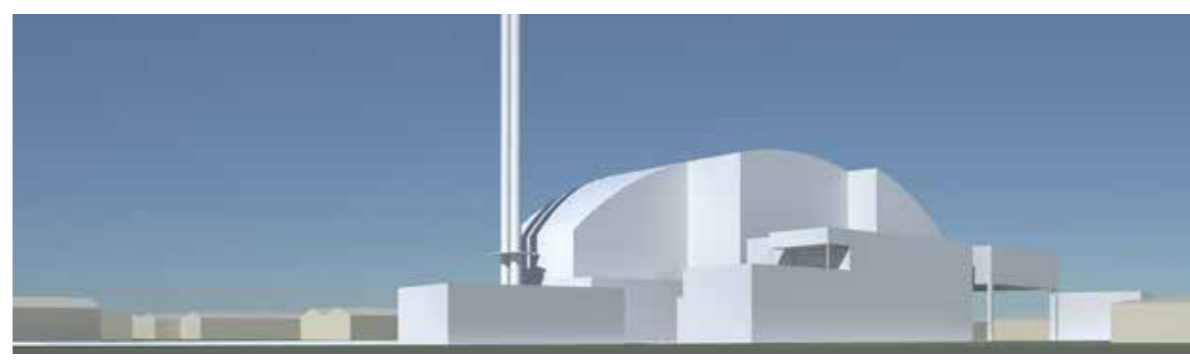
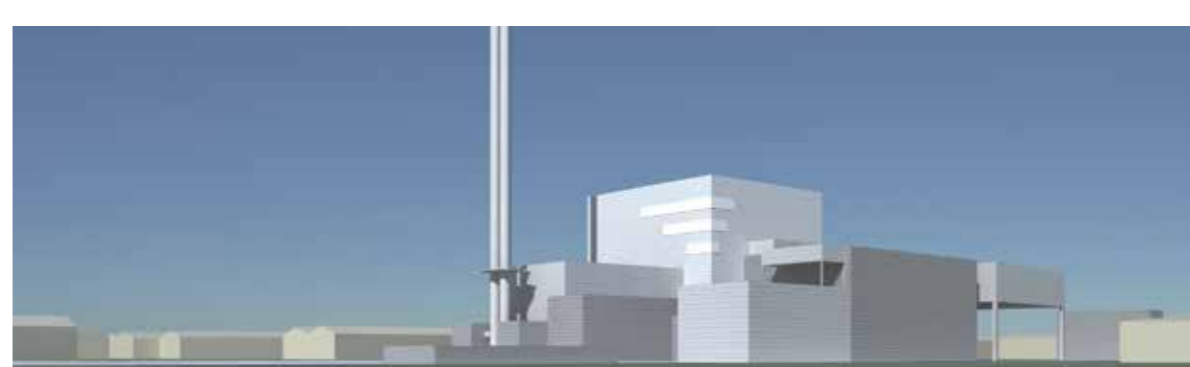

Massing options
as viewed from the eastern end of New Bridge Lane

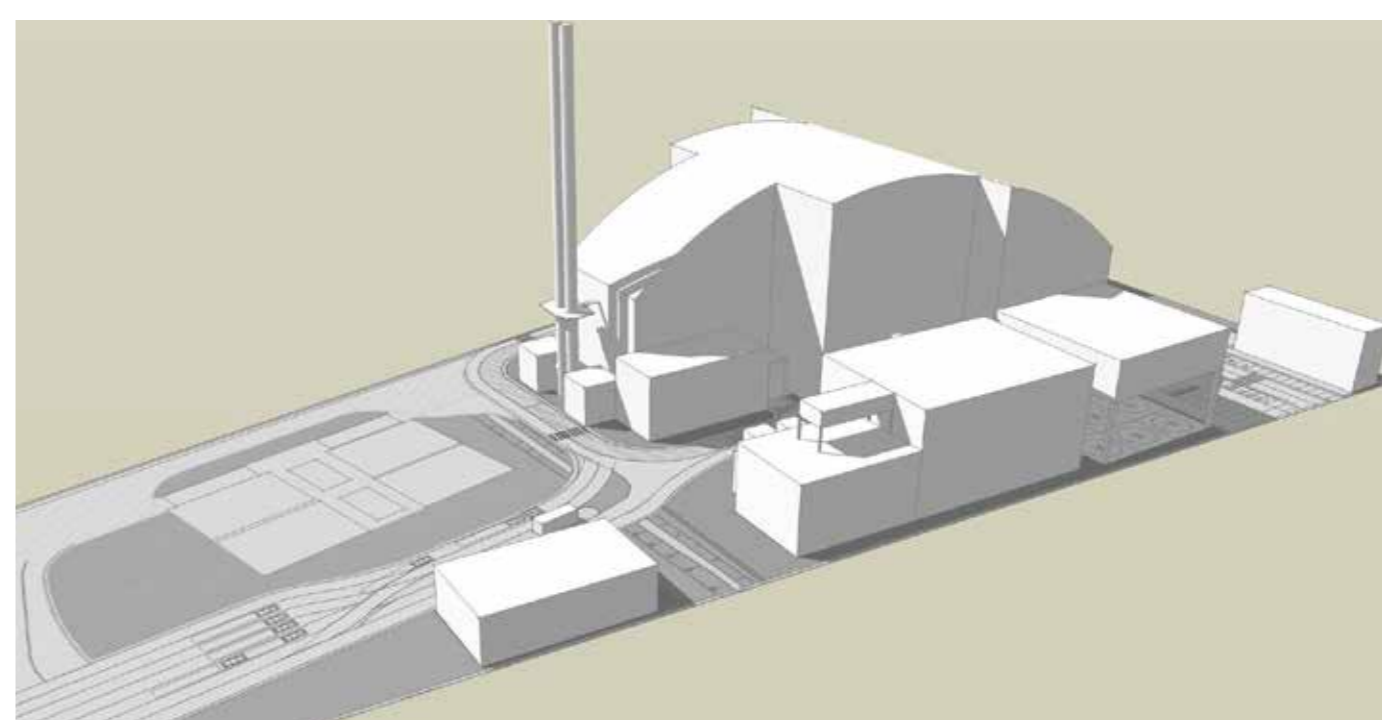

Massing model 4



www.mvv-medworthchp.co.uk